



## Operating instructions

### Heat-Cutter type HSG-0-electronic

Contents	Page
Contents	1
Explanation of symbols	1
Prescribed use	2
Safety notes	2
Functional description	3
Commissioning	4
Handling	4
Maintenance	4
Correction of faults	5
Technical data	5
Environmental conditions	5
Permissible Blades	6
Disposal	6
Warranty	6
Declaration of conformity	7



Pic.:  
HSG-0-electronic with blade type R-50  
(The blade is not included in the  
scope of delivery!)

### Explanation of symbols



This instruction manual is part of this product. Please read this instruction manual carefully and keep it for future use!



Warnings and safety instructions!



Accessible surfaces can get hot when the device is in operation!



Warning of dangerous electrical voltage!



Use eye protection!



Use protective clothing!



Use protective gloves!



The symbol of the "crossed-out garbage can" means that the device must not be disposed of in the household waste!



## Prescribed use

In conjunction with an appropriate blade, the Heat-Cutter shall be used only to separate or to cut synthetic fabric or cords, ropes, bands, and belting fabric. Furthermore, for thermal cutting of insulation made of EPS and XPS (flame retardant according to DIN 4102 or DIN EN 13501).



Any use other than that described above will result in damage to this product, and it will also be associated with hazards such as short circuit, fire, electric shock, etc. The entire product must not be altered or rebuilt and the housing must not be opened!

## Safety notes



**Danger! The thermal processing of plastics produces fumes that are harmful to health!**

When working in rooms, the vapours that arise on the cutting blade during cutting must be removed directly using an extractor fan. Or only work in well-ventilated rooms.

PVC and PVC-coated materials may not be processed due to the harmful vapours arising during cutting.



**Pay attention to the risk of burns when using the machine!**

The cutting blades can reach temperatures of approx. 600° Celsius. Do not touch the cutting blades once you have switched the machine on. Do not lean the device against objects before the cutting blade has cooled down completely.



**Danger! Danger to life due to electric shock!**

A fatal electrical shock can result if water gets into the housing.

Keep the machine away from water.

If water does get in, pull the plug out immediately and do not continue to use the machine.



**Any damage caused as a result of these operating instructions having been ignored will not be covered by the warranty!**

**We will not accept liability for subsequent damage!**

**We will not accept liability for damage or injury caused by inappropriate handling or ignoring of the safety notes. In such cases all warranty rights will become void.**

For safety reasons, unauthorised reconstruction and/or modifications to the thermal cutting device are not permitted.

Only a correctly operating mains socket (230Volt/50Hz) in the public supply network may be used for the power supply.

Do not operate the product in unfavourable ambient conditions.

Unfavourable ambient conditions are:

- Moisture or too high air humidity,
- Dust and flammable gases, fumes, or solvents,
- Strong vibrations.

Always unplug the unit when not used.

The unauthorized conversion and/or modification of the product is inadmissible because of safety and approval reasons (CE).



Make sure that the power cord does not come into contact with heat, oil, or sharp edges during operation of the machine. Damaged power cords can cause fires, short circuiting, and electric shocks.

The connection cable is to be replaced only by the manufacturer or his servicing agent who have a special tool available.

Machines powered by mains voltage do not belong in the hands of children.  
Please exercise special caution when children are present.

The structure of the Cutter complies with the safety class II. Make sure that the insulation of the housing is neither damaged nor destroyed.



Wear appropriate protective clothing, protective gloves and goggles when working.  
Molten plastic and splashes can cause serious burns or eye damage!



## Functional description

In conjunction with an appropriate blade, the Heat-Cutter shall be used only to separate or to cut synthetic fabric or cords, ropes, bands, and belting fabric. No other materials may be cut.

The blade, which is directly heated via an electronically transformer, is heated to 600 °C (1230°F) within 6 to 8 seconds.

All the synthetically material which contacts the blade will melt.  
This causes an uninterrupted, welded edge to form. The edges welded like this will not fray.

An electronic current limiter protects the Heat-Cutter device against overloading and against a short circuit at the blades.

In the event of overloading (e.g. short circuit or wrong adjustment) the output will be turned down.  
Only after the overloading has been corrected will the device be operable again.

In the event of a permanent overload (e.g. non-permitted continuous operation) an integrated temperature limiter will separate the device from the mains power supply. After a cooling time of approx. 15 minutes the device can be used again.



**This device is not for continuous operation, only for intermittent operation.**

12s/48s on the type plate gives, at the front of the slash, the operating period provided an appropriate heat sink is available and, after the slash, the pause period for which the device should be switched off.



## Commissioning

Check that the mains voltage corresponds to that given on the type plate.

Depending on the type of the work to be carried out and the thickness of the material, various blades are available. In this context, please observe the Permissible Blades, See Page 6.

Only insert the blade while the device is switched off.



**When inserting the blade, make sure that it is firmly screwed in so that the current flows easily. Bad connections or loose screws will lead to unnecessary heating up of the clamps, the performance of the blade will be adversely affected and the heating up of one or both of the clamps can lead to the housing becoming burned.**

Now insert the plug of the Heat-Cutter device into a mains socket.

The device is switched on by pressing the switch lever.

The red LED-lamp is illuminated.

After a heating time of several seconds the required blade temperature is reached.



After the work is completed, the device can be put away. The switch lever automatically returns to its limiting position and switches the device off. Unplug the power plug!

**The switch lever must not be mechanically locked or electrically bridged.**

## Handling

Never operate your Heat-Cutter device immediately after taking it from a cold into a warm room. Under unlucky circumstances, the condensation could destroy your Heat-Cutter device.



**First let your Heat-Cutter device reach room temperature without being switched on.**

**The Heat-Cutter device is not permitted for applications near to people or animals.**

## Maintenance

Regularly check the technical safety of your Heat-Cutter device, e.g. damage to the mains connection or to the housing.

If it is likely that safe operation is no longer possible, the device should be taken out of operation and secured against unintended use. Remove the mains plug from the socket!

It must be assumed that safe operation is no longer possible if

- the device shows visible damage,
- the device no longer works and
- after long periods of storage under unfavourable circumstances, or
- after damage during transportation.



**The device may only be repaired by the manufacturer or by their customer service department. The connection cable can only be replaced by using a special tool which the manufacturer or their customer service department has available.**



## Correction of faults

By buying this Heat-Cutter device you have purchased a product which has been constructed safely and reliably according to the current state of technology.

However, problems or faults are possible.

For this reason, we describe below how to correct possible problems:



**Please observe the  
safety notes!**

Problem	Solution
No function	<ul style="list-style-type: none"><li>- Has the switch lever been pressed?</li><li>- Is the mains plug inserted into the socket?</li><li>- Check the socket</li><li>- After overloading wait for approx. 10-15 min.</li></ul>

## Technical data

Operating voltage:	230 V - 50 Hz
Power consumption:	max. 120 Watt
Intermittent operation:	12Sec ON / 48Sec OFF (1/4 min.)
Weight:	approx. 0.45 kg

**This device is not for continuous operation, only for intermittent operation.**

12s/48s on the type plate gives, at the front of the slash, the operating period provided an appropriate heat sink is available and, after the slash, the pause period for which the device should be switched off.

## Environmental conditions

Operating temperature range (min. +max.)	+5°C to +35°C (9° to 65°F)
Relative air humidity:	max. 85 %
Air pressure:	600 to 1000 hPa



## Permissible Blades

Type R-1

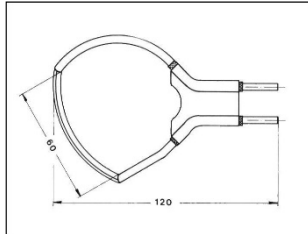

Type R-50

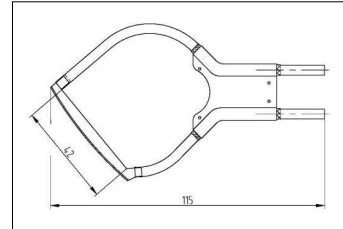

Type VST

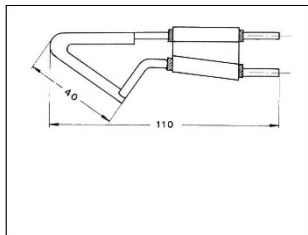

Type F-2

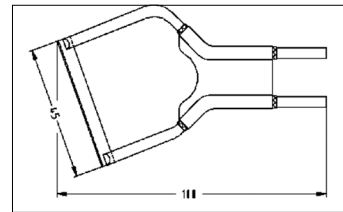

Type HS-S-15°  
with Slit  
and Grinding

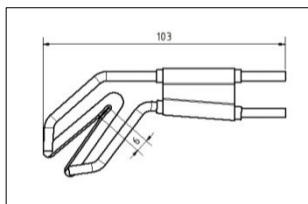

Type N-1  
 $r = \text{max. } 15 \text{ mm}$

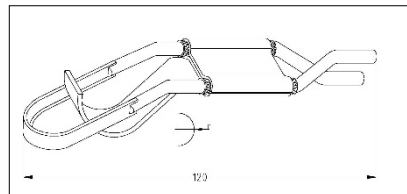

Type N-2  
 $a = \text{max. } 30 \text{ mm}$   
 $r = \text{min. } 1 \text{ mm}$

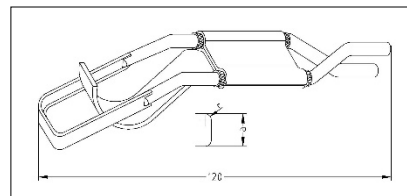

## Disposal

The symbol of the crossed-out garbage can mean that the device must not be disposed of with household waste! An unusable device can be returned to the retailer or manufacturer free of charge or handed in at a designated collection point for electrical and electronic waste.

If the old electrical or electronic device contains personal data, you are responsible for deleting it yourself before returning it.



## Warranty

You will be granted a warranty of **6 months** except for the blade.

The warranty period starts on the day the device is purchased.

All faults caused by possible material or production errors are covered by this warranty.

The warranty lapses if the device is treated inappropriately or for purposes other than intended.



## EC-Declaration of Conformity

According to the directives:

### 2014/30/EU

DIN EN IEC 55014-1 (VDE 0875-14-1):2022-12; EN IEC 55014-1:2021  
DIN EN IEC 61000-3-2 (VDE 0838-2):2019-12; EN IEC 61000-3-2:2019  
EN IEC 61000-3-2:2019/A1:2021  
DIN EN 61000-3-3 (VDE 0838-3):2023-02; EN 61000-3-3:2013+A1+A2+A2/AC:2022  
DIN EN IEC 55014-2 (VDE 0875-14-2):2022-10; EN IEC 55014-2:2021  
Requirements of categories II

### 2014/35/EU

DIN EN 60335-1 (VDE 0700-1):2020-08; EN 60335-1:2012+AC+A11+A13+A1+A2+A14:2019  
DIN EN 60335-2-45 (VDE 0700-45):2012-08; EN 60335-2-45:2002+A1+A2:2012  
DIN EN 62233 (VDE 0700-366):2008-11; EN 62233:2008  
DIN EN 62233 Ber.1 (VDE 0700-366 Ber.1):2009-04; EN 62233 Ber.1:2008

### RoHS Directive 2011/65/EU

Hereby we declare that the designated product complies with the essential requirements of the above-mentioned Directives, when used for its intended purpose. In the case of a change of the product not co-ordinated with us this explanation loses its validity.

**Manufacturer:** HSGM Heißschneide-Geräte und Maschinen GmbH  
Industriestrasse 30  
D – 65366 Geisenheim

### Description of the device:

- Product: Plastic cutting tool
- Type: HSG-0-electronic
- Electrical data: 230 V, 50 Hz

**Date of Declaration:** 17.04.2024

**Signature:**

**Name and position of the signer:** Stephan Herrmann / Director